

15235

File

PROPERTY NUMBER

OWNER: KAVIER DAVID

LESSEE: RUI & SUMNER

SPECIFIC LOCATION:

ADDITIONAL PROPERTY INFORMATION: 2 MI W OF SUTHERLAND AVE ON S SIDE OF LEMON AVE

INSPECTION - TREATMENT RECORD

SAN JOAQUIN COUNTY MOSQUITO ABATEMENT DISTRICT

35230

ADDRESS: 29094 E LEMON AVE ESCALON CA

ADDRESS: \_\_\_\_\_ SOURCE TYPE GOZ, OLY

249 120-032

**OS** Date

Date	Source #	Source Type	Genus + Instar	Time	Activity	Pesticide	Quantity Used				Area		No. Treated	Treat- ment Time	Misc. Remarks	Emp. #	Inlt.
							Gals.	Lbs.	Oz.	Ea.	Acres	Sq. ft.					
8/19	2	OLY	CX-L	5	L	GG	5		640		1.25		15			310	C
9/12	2	OLY	CX-L	5	L	GG	3		384		0.75		10			311	C
9/12	1	GOZ	CX-L	5	L	GG	3		384		0.75		10			311	C
9/19	1	GOZ	CX-L	5	L	GG	2		256		0.5		10			310	C
9/19	2	OLY	CX-L	5	L	GG	5		640		1.25		15			310	C
10/6	2	OLY	CX-L	5	L	GG	5		640		1.25		15			310	C
10/8	2	OLY	CX-L	5	L	GG	5		640		1.25		15			310	C
11/1	4	GOZ	CX-L	5	L	GG	2		256		0.5		15			310	C
12/6	1	GOZ		10												310	C
5/8	2	OLY	CX-L	10	L	VE	25		200		4.25		40			310	C
5/17	2	OLY	CX-L	10	L	GG	10		1280		2.5		20			310	C
5/17	1	GOZ	CX-L	5	L	GG	3		384		0.75		10			310	C
7/7	1	GOZ	CX-L	5	L	GG	5		640		1.25		15			310	C
7/19	1	GOZ	CX-L	5	L	GG	10		1280		2.5		15			310	C
7/19	1	OLY	CX-L	5	L	GG	5		640		1.25		15			310	C
8/14	1	OLY	CX	5	L	GG	5		640		1.25		15			310	C
8/14	2	GOZ	CX	5	L	GG	6		768		1.5		15			310	C
8/14	2	GOZ		5	L	GG	75		960		1.25		15			310	C
8/14	2	OLY	CX	5	L	GG	5		640		1.25		15			310	C
9/11	1	OLY	CX	5	L	GG	3		384		0.75		10			310	C
9/11	1	GOZ	CX	5	L	GG	3		384		0.75		10			310	C
9/11	1	GOZ	CX	5	L	GG	10		1280		2.50		15			310	C
9/11	1	GOZ	CX	5	L	GG	64		64		13.50		80			317	C

PT=3203. Handman (9:10-10:20)

3rd. Hand (8:15-8:35)

DRIVEN 330

LOC # 15235

file

PROPERTY NUMBER  
ZONE T R S

18259E11 002

249-120-032

INSPECTION - TREATMENT RECORD

SAN JOAQUIN COUNTY MOSQUITO ABATEMENT DISTRICT

OWNER: **XAVIER DAIRY** ADDRESS: **29094 E LEMON AVE ESCALON 95320**

LESSEE: **RUI & SENNIE** ADDRESS: **29094 E LEMON AVE ESCALON 95320**

SPECIFIC LOCATION: **1/2 mi W. OF SUTHER RD ON S. SIDE OF LEMON**

ADDITIONAL PROPERTY INFORMATION: **Tom Morgan 317**

Date	Source #	Source Type	Genus + Instar	Time	Activity	Pesticide	Quantity Used				Area		No. Treated	Treatment Time	Misc. Remarks	Emp. #	Int.
							Gals.	Lbs.	Oz.	Ea.	Acres	Sq. ft.					
6/14	1	014		15	H	RP	1.25		1.60		2.50		75		(see excess) CAN NOT GET TO POUNDS PT = 80 oz All hand driven 336	310	C
6/15	1	014				G-G	5		640		1.25		15			310	C
6/15	1	014	CX-L	10	L	G-G	5		640		1.25		15			310	C
6/24	1	014	CX-L	5	L	G-G	2		250		0.5		10			310	C
6/28	2	008	CX-L	5	L	G-G	4		512		1.0		10			310	C
7/28	2	008	CX	5	L	G-G	4		768		1.5		15			310	C
8/23	1	014	CX	5	L	G-G	5		440		1.25		15			310	C
8/23	2	008	CX	5	L	G-G	4		512		1.0		10			310	C
9/22	2	014	CX	5	L	G-G	4		512		1.0		10			310	C
10-0	1	014	CX	5	L	G-G	4		512		1.0		10			310	C
10-6	1	009	CX	5	L	G-G	5		640		1.25		15			310	C
10-16	1	014	CX	10	L	G-G	6		640		1.25		15			310	C
10-30	1	014	CX	10	L	G-G	3		384		0.75		15			310	C
11/8	2	008	CX	10	L	G-G	4		512		1.0		15			310	C
11/15	3	008	CX	10	L	G-G	5		640		1.25		15			310	C
3/29/07	1	014		10:0												336	C
3/29	3	008		10:0												336	C
3/29	2	014		10:0												317	C
4/24	1	014	CX-L	15:0	L	XP			70	2		100	1	10		317	C
5/15/07	1	014	CX-L	10	L											317	C
5/21/07	1	014	CX-L	5	L	1/E			80		2.50		15			317	C

NO ACCESS TO POUNDS. ?

No roadside access. Driver not found.  
Top 1/2 inch, two spray  
8/150 - 5/15

15235  
PROPERTY NUMBER

18259511002  
ZONE T R S

249-120-032

INSPECTION - TREATMENT RECORD

SAN JOAQUIN COUNTY MOSQUITO ABATEMENT DISTRICT

OWNER: Xavier Dairy ADDRESS: 29094 E Lemon Ave Esc. 95320

LESSEE: Rui & Jennifer ADDRESS: 587-1975 SOURCE TYPE: 002, 014, 008

SPECIFIC LOCATION: Rui Cell ph.# (209) 587-1975

ADDITIONAL PROPERTY INFORMATION: 1/2 mi W. of Suttiff Rd on S side of Lemon

**T. P. Evans**

Date	Source #	Source Type	Genus + Instar	Time	Activity	Pesticide	Quantity Used				Area		No. Treated	Treat-ment Time	Misc. Remarks	Emp. #	Int
							Gals.	Lbs.	Oz.	Ea.	Acres	Sq. ft.					
7/30	1	014	Gx-L	5	L	VE	10		80		2.50		10		Mc Rui: Will begin inspecting 7/31 (1:45-2:20)	317	
7/31	1	014	Gx-L	10	L	XP			70	2	1.25		2		Mixed pump spray side	317	
7/31	1	014	Gx-L, P	15	L	G.G.	10		180		2.50		20		Blow's Area (12:55-1:15)	317	
7/31	1	014	Gx-L	10	L	VE	10		80		2.50		15		Blow (1:10-1:35)	317	
7/31	1	014	Gx-L	5	L	VE	10		80		2.50		15		Blow (10:40-11:15)	317	
7/31	1	014	Gx-L	15	L								10		Blow (11:15-11:40)	317	
7/31	1	014	Gx-L	10	L				50		1.75		10		Blow (11:15-11:40)	317	
7/31	1	014	Gx-L	20	L										Blow (12:40-1:20) inspect. 1:50-2:10	317	
7/31	1	014	Gx-L	10	L										15 mile hour wind	317	
7/31	1	014	Gx-L	15	L	B.G.	13		128		1.25		5		8:30-9:10	317	
7/31	1	014	Gx-L	10	L	G.G.	8		104		2.		20		gun 1:10-1:40	317	
7/31	1	014	Gx-L	10	L	G.G.	10		180		2.5		15		small weeds.	317	
7/31	1	014	Gx-L	5	L	G.G.	6		78		1.5		10		WEEDS!	317	
7/31	1	014	Gx-L	5	L	G.G.	8		104		2.00		12		same to winter re: weeds.	317	
7/31	1	014	Gx-L	5	L	G.G.	7		896		1.75		10		Rui sprayed weeds today. Under 1/4 inch	317	
7/31	1	014	Gx-L	10	L	G.G.	1		138		.25		10		on E/ side of 002 road, Towards	317	
7/31	1	014	Gx-L	5	L	VE	6		48		1.50		10		Blow	317	
7/31	1	014	Gx-L	5	L	VE	4		512		1.00		10		Blow	317	
7/31	1	014	Gx-L	5	L	G.A.	0.75		36		.18		8		Blow + hand	317	
7/31	1	014	Gx-L	5	L	VE	12		96		3.00		12		Blow	317	
7/31	1	014	Gx-L	5	L	VE	10		80		2.50		13		Blow	317	
7/31	1	014	Gx-L	5	L	VE	1		8		.25		3		hand	317	

day 1

day 1

File Ponds Lemon

Contact Information:

Owner:

XAVIER ROSE (DAIRY)

Lessee:

Map

Refer to

Evaluation

Keith Weinhaus

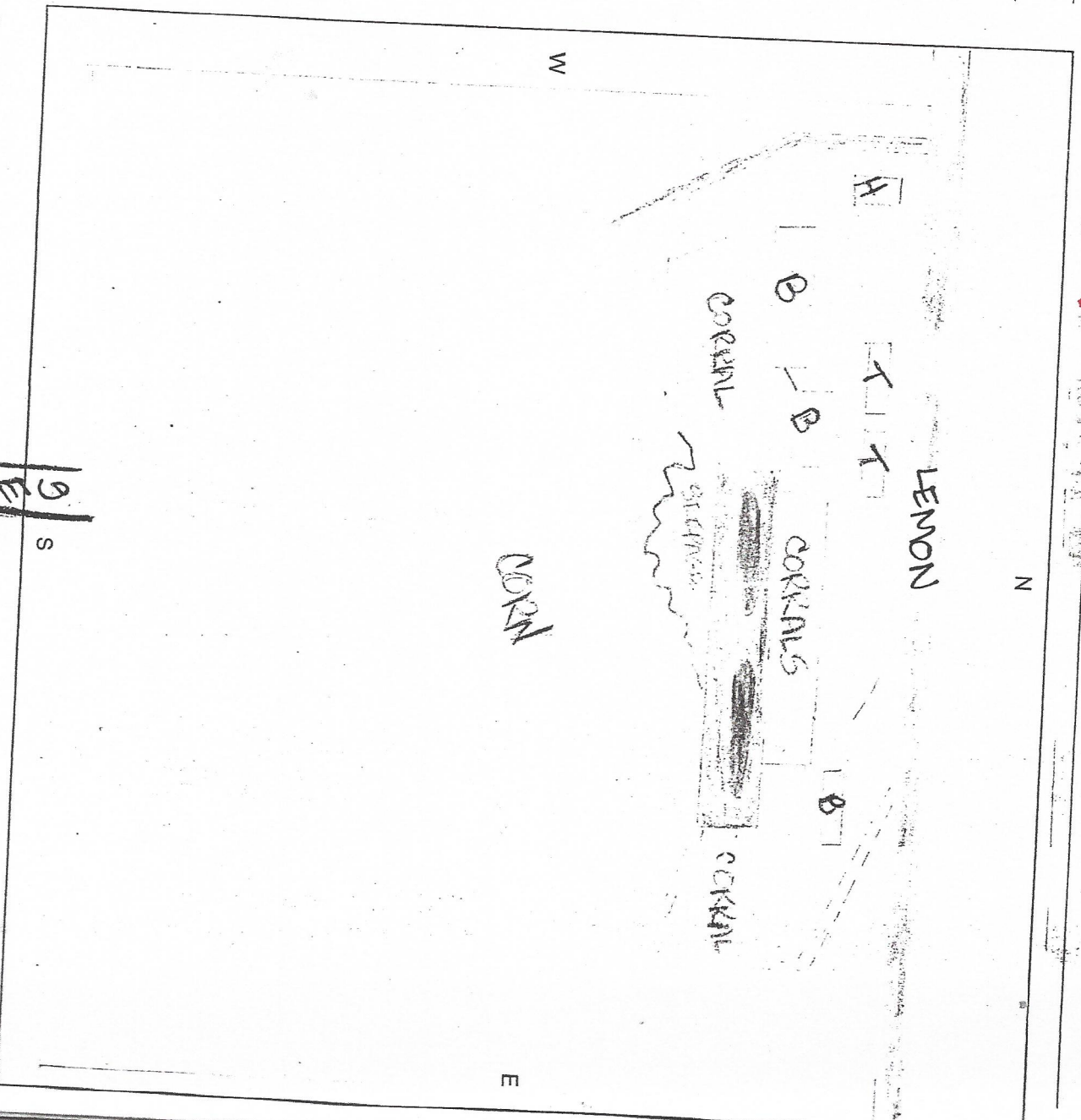

Specific Location:

S  
E  
D