

19 20 21 22

LONE TREE

BUERER

1.3-2.3  
2.4-2.3

Jan  
Den  
Mick  
Deanna  
Steve  
Tiffany  
**T1S R9E**

BRENNAN

ESCALON-BELLOTA

MAGNOLIA

12

MAHON

LAWRENCE

BEELER

31

ARTHUR

32

DECK

CAMPBELL

34

OWENS

HASKELL

ESCALON

DANIELLE

MILLER

LA MESA

MISSION

120

UP

FARINELLI, NOMI, CROCE, WALNUT, IRWIN, FISK, OKLAHOMA, PARK, DANIELS, SWANSON, SUIEN, SACRAMENTO, STANISLAUS, YOSEMITE, BONDS, JUSTIN, NATHANIEL, CALIFORNIA, JACKSON, EDMART, VERNON, SPRING, JILL, BEILE

120

6

SANCHEZ

CARIGNANE

ULLREY

5

BAKER

PARK

DANIELS

SWANSON

DEBORAH

SOPHIE

MAIN

COLE

BRAYTON

EDMART

VERNON

SPRING

JILL

BEILE

120

3

VINE

18

CATHERINE

**T2S R9E**

17

NARCISSUS

NARCISSUS

DAHLIN

CLOUGH

ST JOHN

SANTA FE

HARROLD

LEMON

7

8

ELLIS

CLOUGH

9

10

JONES

WIGLEY

STONE

MEYERS

LONE OAK

17

16

15

East Union - 13157E31010  
1.3316  
1.13 Acre

Valley Home - 18159E24024  
1.9516  
1.38 Acre

~~East Union~~

St John - 17158E34003  
1.6716  
1.67 Acre

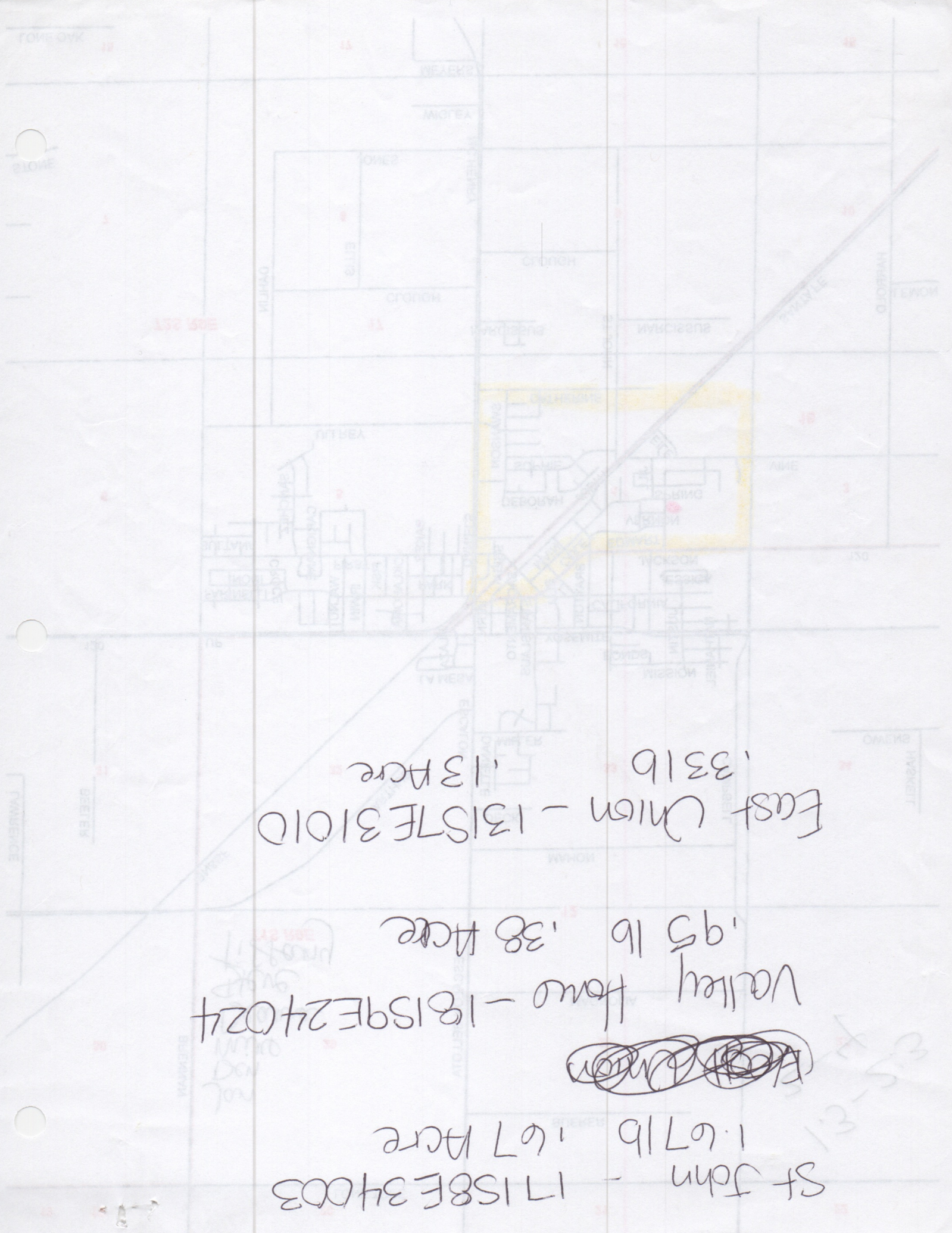

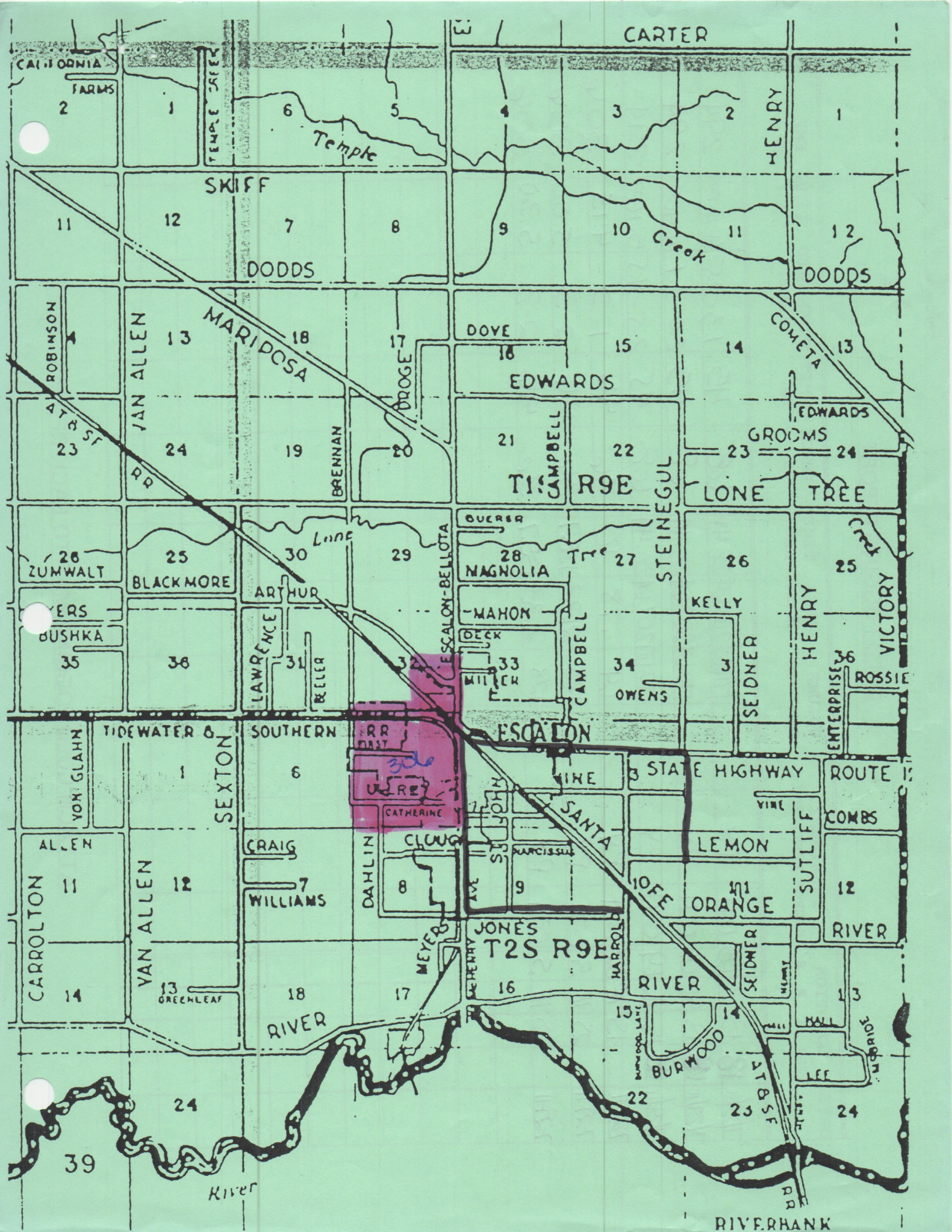

CARTER

CALIFORNIA FARMS  
2

FENCE LINE

Temple

HENRY

SKIFF

DODDS

Creek

DODDS

ROBINSON  
4  
47 8 ST

VAN ALLEN  
13

MARIPOSA

DROGE  
17

DOVE  
16

EDWARDS

14

COMETA  
13

BRENNAN

T11S R9E  
CAMPBELL  
21

R9E

LONE

EDWARDS

GROOMS

TREE

ZUMWALT  
26

BLACKMORE  
25

ARTHUR

LINE

29

QUERER

MAGNOLIA  
28

TREE  
27

STEINEGUL

26

TREE

YERS  
BUSHKA  
35

36

LAWRENCE

31

BELER

ESCALON-BELLOTA

MAHON

DECK

MILNER  
33

CAMPBELL

34

OWENS

KELLY

SEIDNER

HENRY

36

ROSSIE

VICTORY

TIDEWATER & SOUTHERN RR

SOUTHERN RR

RR EAST

ESCALON

VINE

STATE HIGHWAY

ROUTE 15

VON GLAHN

SEXTON

1

6

30  
UREY

CATHERINE

JOHN

SANTA

VINE

COMBS

ALLEN

CRAIG

DAHLIN

CLOUD

MARCISSE

LEMON

SUTLIFF

12

CARROLTON  
11

VAN ALLEN  
12

WILLIAMS  
7

8

9

JOHN

10

ORANGE

12

14

VAN ALLEN

18

17

16

JONES  
T2S R9E

RIVER

11

RIVER

13

GREENLEAF

18

17

16

15

RIVER

14

13

24

24

24

22

22

BURWOOD

22

23

24

39

39

39

39

39

39

39

39

39

River

RIVERBANK

# COLD FOGGING REPORT

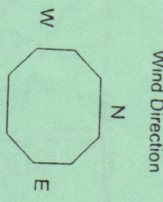

| DATE    | LOCATION | TREATMENT        | VOLUME    | AREA  | TIME   | TRUCK  | UNIT  | WINDSPEED | TIME | EMP     |         |     |
|---------|----------|------------------|-----------|-------|--------|--------|-------|-----------|------|---------|---------|-----|
| Zone    | T R S    | SOURCE PESTICIDE | Gals. Ozs | ACRES | MIN.   | No.    | No.   | M.P.H.    |      | No.     |         |     |
| 7/29/11 | 18       | 15 9E 03         | 071       | PY    | 170.67 | 207.64 | 28.44 | 608       | 45   | 1.3-2.5 | 4:00 AM | 294 |
| 7/29/11 | 18       | 15 9E 04         | 071       | PY    | 170.67 | 207.64 | 28.44 | 608       | 45   | 2.0-3.1 | 4:40 AM | 294 |
| 7/29/11 | 18       | 15 9E 09         | 071       | PY    | 170.67 | 207.64 | 28.44 | 608       | 45   | 2.5-4.5 | 5:10 AM | 294 |
| 7/29/11 |          | 15 9E 32         | 071       | PY    | 64     | .78    | 10    | 36        | 46   | 1-2     | 4:15    | 306 |
| 7/29/11 |          | 25 9E 5          | 071       | PY    | 128    | 21.33  | 15.7  | 36        | 46   | 2-3     | 5:00    | 306 |
| 7/29/11 |          | 25 9E 5          | 071       | PY    | 128    | 21.33  | 15.7  | 36        | 46   | 2-3     | 5:30    | 306 |

ATTACH COLD FOGGING MAP TO BACK OF THIS SHEET