

#15320

PROPERTY NUMBER

ZONE T R S
19 15 8 23 031

205.110.04

INSPECTION - TREATMENT RECORD

SAN JOAQUIN COUNTY MOSQUITO ABATEMENT DISTRICT

OWNER: Brasil's Sons Inc.

ADDRESS: 21728 Lone Tree Rd. Esc. 95320

LESSEE:

SOURCE TYPE 014018, 020, 019

SPECIFIC LOCATION:

NW corner Lone Tree Van Allen.

ADDITIONAL PROPERTY INFORMATION:

INSPECTION				TREATMENT						Area	No. Treated	Treatment Time	Misc. Remarks	Emp. #	Int.
Date	Source #	Source Type	Genus + Instar	Activity	Pesticide	Gals.	Lbs.	Oz.	Ea.						
9/14/07	1	020	cxL	L	GG	3.0	384			1.75		5.		337	C
9/14/07	2	018	Ø											337	
9/14/07	3	014	Ø											337	
9/14/07	4	014	cxL	L	GG	5.0	640			1.25		5.		337	C
9/14/07	5	018	Ø											337	
9/28/07	1	020	cxL	L	GG	4.0	768			1.50		5.0	IN-out 1:10-2:00	337	C
9/28/07	4	014	cxL	L	GG	5.0	640		120	1.25		5.0		337	C
9/28/07	2	018	Ø	X	FS	2.0	256					10.0		337	C
9/28/07	3	014	cxL	L	GG	5.0	640			1.25		5.0	IN-out 1:20-2:00	337	C
10-25-07	1	020	Ø											337	C
10-25-07	4	019	cxL	L	GG	1.0	128			0.5		5.		337	C
10-25-07	3	014	Ø											337	
10-25-07	4	014	cxL	L	GG	4.0	512			1.0		5.		337	C
11-14-07	1	020	Ø											337	C
3-11-08	1	020	Ø											337	C
3-11-08	2	018	Ø											337	C
6-9-08	4	019	cxL	L	XG	2.0	32			.4		20.		337	C
6-9-08	1	020	Ø											337	C
6-9-08	2	018	Ø											337	C
6-9-08	3	014	Ø											337	C
6-9-08	1	020	cxL-P	L	VE	1.0	80			.25		5.0	holding in send.	337	C
7-1-08	1	020	cxL-P	L	GG	.25	32			.025		5.0		337	C
7-1-08	2	018	cxL	L	VE	3.0	64			2.0		5.0		337	C

P/CW/george for info.

Contract Information:

05.
1114

Owner:

Becker

Lessoc:

37°50.04.8" 121°03.48.8"
 37°50.04.6" 121°03.24.5"
 37°50.04.8" 121°03.22.2"
 37°50.04.3" 121°03.20.6"
 37°50.49.51.7" 121°03.19.6"
 37°49.50.8" 121°03.22.6"

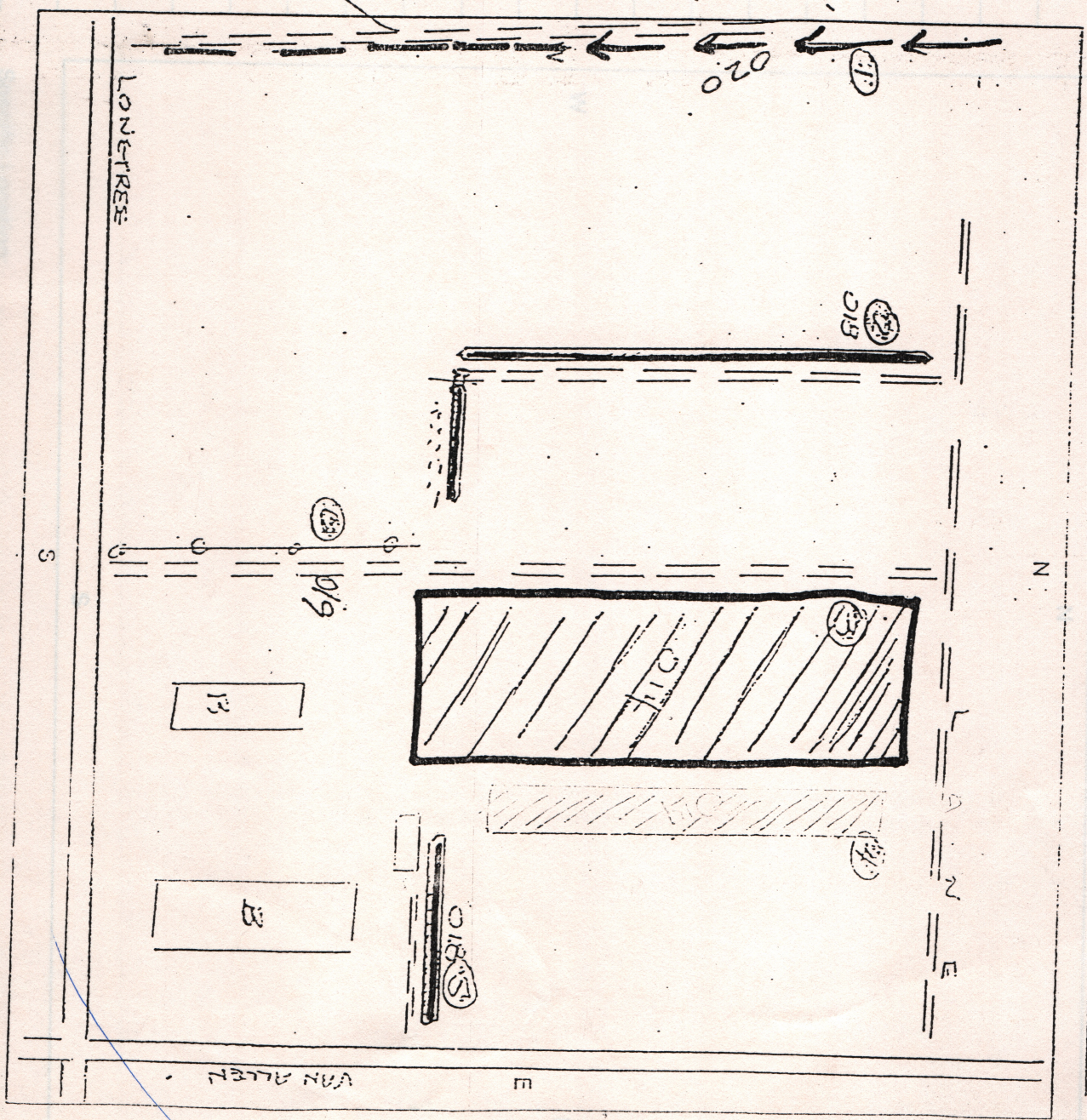

Specific Location:

VAN ALLEN

LONESTREE

N

S

E

A N E