

160. # 15138  
 PROPERTY NUMBER  
 ZONE T R S  
 12 15 9E 35 009

INSPECTION - TREATMENT RECORD  
 Fyler DANA

OWNER: Fyler DANA  
 LESSEE: Kelly - Seidner rds  
 SAN JOAQUIN COUNTY MOSQUITO ABATEMENT DISTRICT  
 ADDRESS: 16829 S Seidner Escalon  
 SOURCE TYPE 003

Seidner (N)  
 30

229-160-029

COUNTY ROAD DISTRICT # \_\_\_\_\_ COUNTY FLOOD CONTROL ZONE # \_\_\_\_\_ IRRIGAT

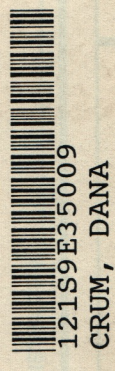

Date	INSPECTION			TREATMENT				Quantity Used		Area		No. Treated	Treat-ment Time	Air Map (✓)	To Be Billed (✓)	Misc. Remarks	Int'l. #
	Source Type	Genus + Instar	Time	Activity	Pesticide	%	Gals.	Lbs.	Oz.	Ea.	Acres						
8/19	003	0	.1	L	GG		-5				.125		.1				328 C
8/24/00	003	AE 3-4	.1	L	GG						.25		.1				328 C
9/18	003	AE 3-4	.1	L	GG						.25		5.0				328 C
10/6	003	AE 3-4	.1	L	GG						.25		5.0				328 C
10/20	003	AE 3	2.0	L	GG		2.0	8			.25		5.0				328 C
12/10	003	AE 3	1.0	L	GG		2.0	32			.25		5.0				328 C
5/25/04	003	0	2.0	L	GG												328 C
6/11/04	003	0	2.0	L	GG												328 C
6/25/04	003	0	5.0	L	GG												328 C
5/3/05	003	0	10	L	GG												328 C
5/16	003	0	10	L	GG												328 C
6/19	003	0	5	L	GG		2	250			0.5		10				328 C
7/10	003	0	5	L	GG		2	250			0.5		10				328 C
9/12	003	0	5	L	GG		1	125			0.25		10				328 C
10/11	003	0	5	L	GG		1	125			0.25		10				328 C
5/28/00	003	AE-L	5	L	GG		3	384			0.75		15				328 C
5/21	003	AE-L	5	L	GG		3	384			0.75		15				328 C
7/20	003	AE	5	L	GG		3	384			0.75		15				328 C
8/15	003	AE	5	L	GG		3	384			0.75		15				328 C
8-8-07	003	—	15	L	GG												328 C
9/09/09	003	—	5	L	GG												328 C

2 Em. Area Holding in front



Contact Information: \_\_\_\_\_

GPS 003 = 37° 48' 38.7"

120° 57' 20.8"

East

8-8-07 Pasture disked

+ dry ditch south of

property holding clean

water. West Pasture has

fresh water. South end

is dry but has potential

to breed when irrigated

✓

Owner: \_\_\_\_\_

Clyde Davis

Lessee: \_\_\_\_\_

N

Kelly Rd

MANKILLER

W

003

S

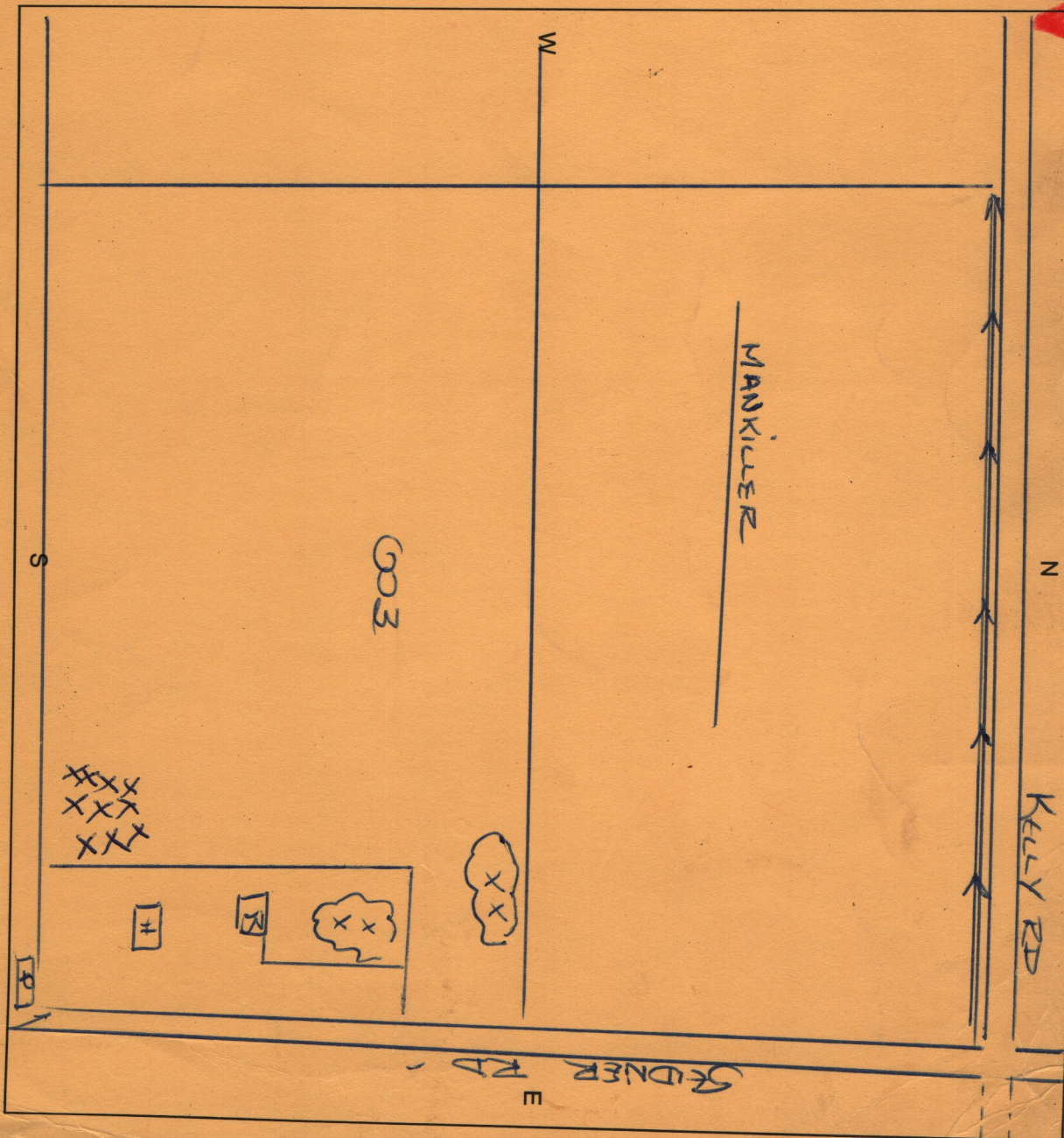

Specific Location: \_\_\_\_\_

110