



Contact Information:

041

① N 37° 45' 12.2' } common.

W 121° 27' 25.0' } DRAIN

② N 37° 44' 48.8' } 105

W 121° 27' 23.5' }

③ N 37° 44' 36.2' } 105

W 121° 27' 25.6' }

④ N 37° 44' 37.5' } 105

W 121° 27' 36.1' }

⑤ N 37° 44' 37.9' } 105

W 121° 27' 37.9' }

⑥ N 37° 44' 50.7' } 105

W 121° 28' 34.4' }

⑦ N 37° 44' 45.3' } 105

W 121° 28' 35.5' }

⑧ N 37° 45' 14.5' } CG

W 121° 28' 34.8' }

① G-PS 2009

② 37° 45' 13.4' } CG

121° 27' 33.5' }

Owner:

City of Tracy

Lessee:

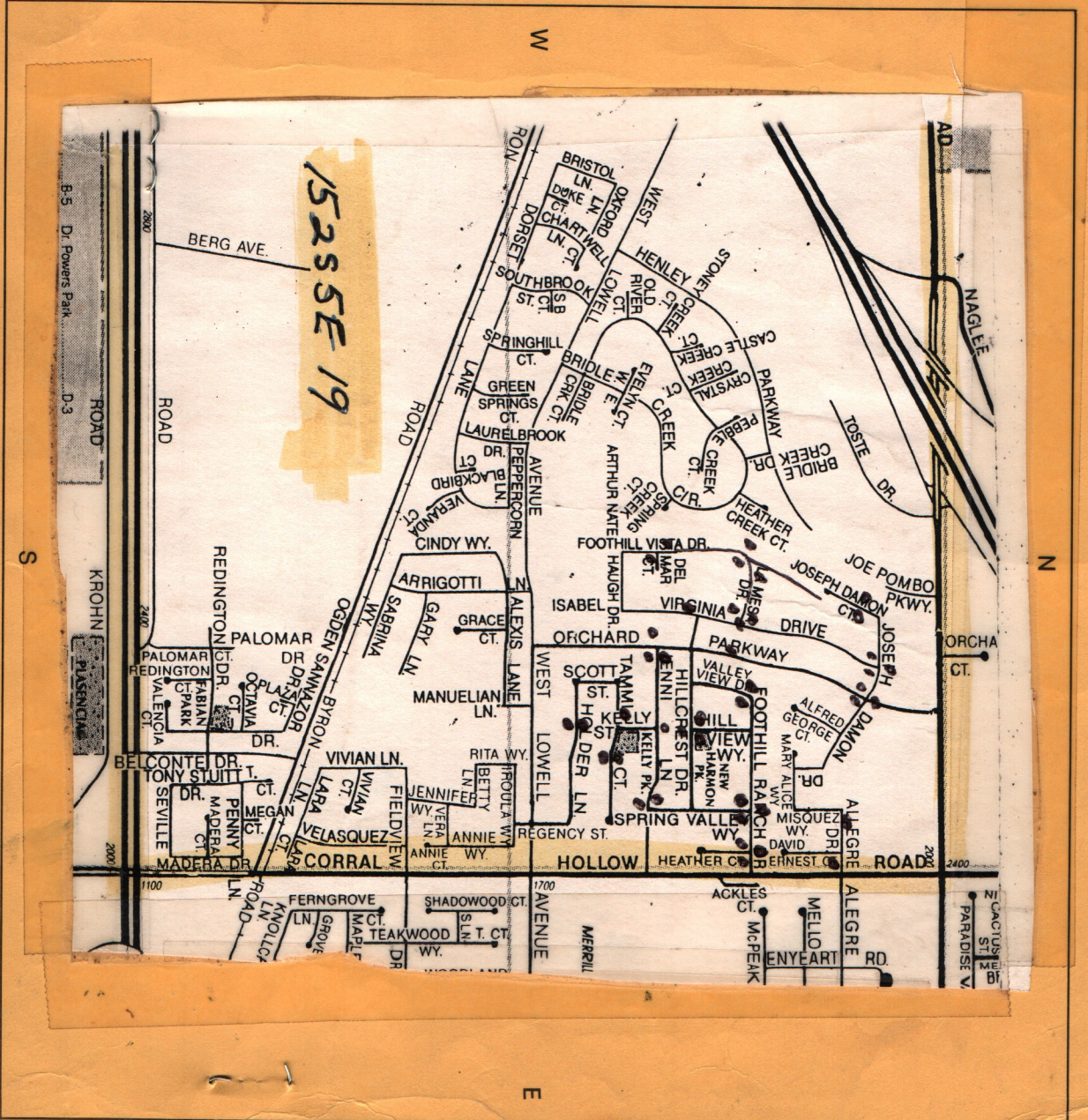

Specific Location:

Grout line - Lammers - Corral Hollow - 11th St