

HULLER 31

INSPECTION - TREATMENT RECORD SAN JOAQUIN COUNTY MOSQUITO ABATEMENT DISTRICT

PROPERTY NUMBER

ZONE	T	R	S
07	2A	BE	02 006

OWNER: LINDEN NYR CO. ADDRESS: P.O. Box 56, LINDEN

LESSEE: DEMARTINI/MARIA & JOHN ADDRESS: _____ SOURCE TYPE 003, 028, 020, 092

SPECIFIC LOCATION: COMSTOCK RD. - 1 MI. E. OF CLEMENTS RD. N/SIDE

ADDITIONAL PROPERTY INFORMATION: _____

065-240-07

INSPECTION				TREATMENT										Emp. #	Intl.	
Date	Source #	Source Type	Genus + Instar	Time	Activity	Pesticide	Gals.	Lbs.	Oz.	Ea.	Acres	Sq. ft.	No. Treated			Treat-ment Time
3-15	2	028	CX-L	10.0	L	VC	8.0		32.0		2.0			10.0		363 C
3-15	3	020	CX-L	10.0	L	VC	16.0		64.0		4.0			20.0		363 C
3-15	4	092	CX-L	10.0	L	VC	8.0		32.0		2.0			10.0		363 C
6-4-04	2	028		10.												306 GW
6-11-04	3	020	CX-L	15	L	AB			3.04	16		1600		25.		306 C
6-17-04	2	028	CX-L	10	L	VE	1.		8		.25			5		306 C
6-17-04	2	028	CX-P	10	L	GG	.5		.51	3	.13			5		306 C
6-17-04	4	092	CX-L	5	L	AB			10		.2		300	5		306 C
7-12-04	1	003	CX-L	5	L	XG	3		100		.75			10		306 C
7-12-04	4	092	CX-P	5	L	GG			254					15		306 C
8-13-04	3	020	CX-P	5	L	GG	1		128		.25			10		306 C
8-13-04	4	092	CX-L	5	L	AB			95	5		500		5		306 C
9-10-04	1	003	CX-L	5	L	AP			11		4			5		306 C
9-10-04	3	020	CX-L	5	L	AB			57	3		300		5		306 C
9-10-04	3	020	CX-L	5	L	AX			768	6		1200		5		306 C
9-10-04	1	003	CX-P	5	L	GG	2		256		.5			5		306 C
9-10-04	4	092	SLL	5	L	AB			95	5		500		5		306 C
10-5-04	1	003	CX-P	25	L	GG	2		256		.5			15		306 GW
11/5/05	1	092		25												305
5/3/05	1	003		15												305
5/3/05	4	092		5												305
6/16	1	603		15												305
6/16	1	092		5												305

Spin walled me around property showing me sources and explaining operations about water use and seasons. Most helpful find literature to give.

Contact Information: _____

① 003 N 38° 03' 17.2"

W 121° 03' 17.9"

② 028 N 38° 03' 17.9"

W 121° 03' 17.9"

③ 020 N 38° 03' 18.1"

W 121° 03' 15.5"

④ ^{Swamp} 092 N 38° 03' 18.0"

W 121° 03' 18.3"

Owner: LINDEN Nut Co.
Lessee: DEMARTINI/MARCIA & SON

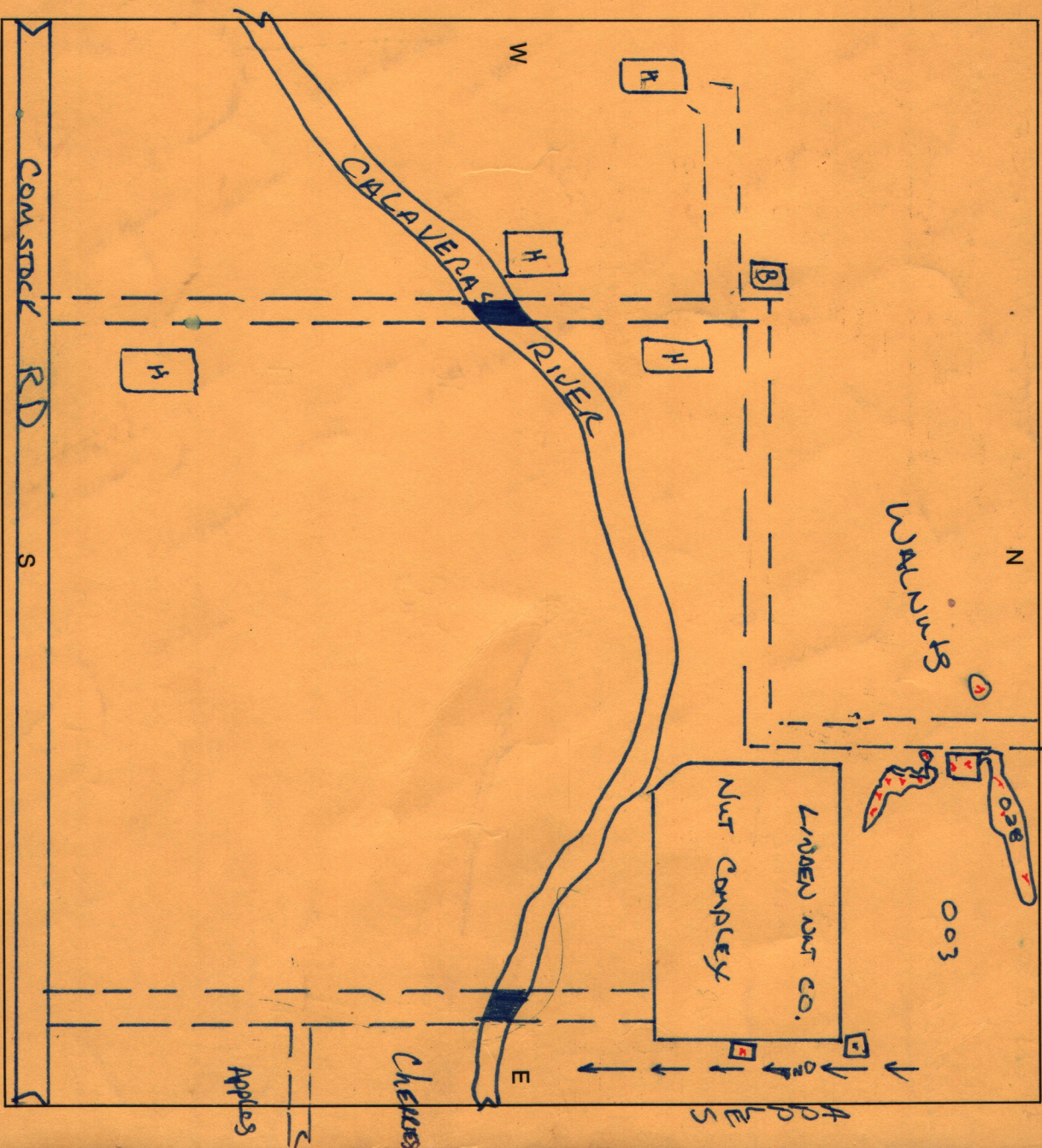

Specific Location: Comstock Rd - 1MI. E. OF CLEMENS RD.

N/SIDE