

INSPECTION - TREATMENT RECORD SAN JOAQUIN COUNTY MOSQUITO ABATEMENT DISTRICT

14560
PROPERTY NUMBER

ZONE T R S

15 25 SE 28 001

OWNER: C.O.T.
LESSEE: Tracy Cemetery

ADDRESS: ADDRESS: 9107 W. Schulte SOURCE TYPE 020' 066

SPECIFIC LOCATION:

ADDITIONAL PROPERTY INFORMATION:

INSPECTION				TREATMENT						Area	No. Treated	Treat-ment Time	Misc. Remarks	Emp. #	Intl.
Date	Source #	Source Type	Genus + Instar	Activity	Pesticide	Gals.	Lbs.	Oz.	Ea.						
9-1	2	020	4A	A	50	8	6.0			2.0		20		346	C
11-5	2	020	9												
11-9	1	066													
2-007					2007										
3-19	1	046	4												
4-14	1	046	9												
6-12	1	046		L	AP		2.5	40		1.0		3.6		375	C
6-12	1	046		L	AP		2.5	40		1.0		3.6		336	C
6-12	1	046		L	AP		2.5	40		1.0		3.6		357	C
6-12	1	046		L	AP		2.5	40		1.0		3.6		295	C
6-12	1	046		L	AP		2.5	40		1.0		3.6		370	C
6-12	1	046		L	AP		2.5	40		1.0		3.6		317	C
6-12	+	046		t	AP										
2008						2008									
3-5	1	066		L	AP		3.17	50.7		1.25		4.7		319	C
3-5		046		L	AP		3.17	50.7				4.7		370	C
3-5				L	AP		3.17	30.102				4.7		345	C
3-5				L	AP		3.17	50.7				4.7		306	C
3-5				L	AP		3.17	50.7				4.7		337	C
3-5				L	AP		3.17	50.7				4.7		295	C

Contact Information: _____

① N 37° 43' 37.7" } 020
W 121° 25' 11.9" }

② N 37° 43' 36.8" } 011
W 121° 25' 14.4" }

N 37° 43' 37.2" } 020
W 121° 25' 11.7" } 008
GPS

N 37° 43' 37.2" } 011
W 121° 25' 14.4" } 003
GPS

Owner: Carriage Funeral Serv. of CA.

Lessee: 1900 St. James Place, 411 Houston Tx. 77056

N 11th St

McArthur

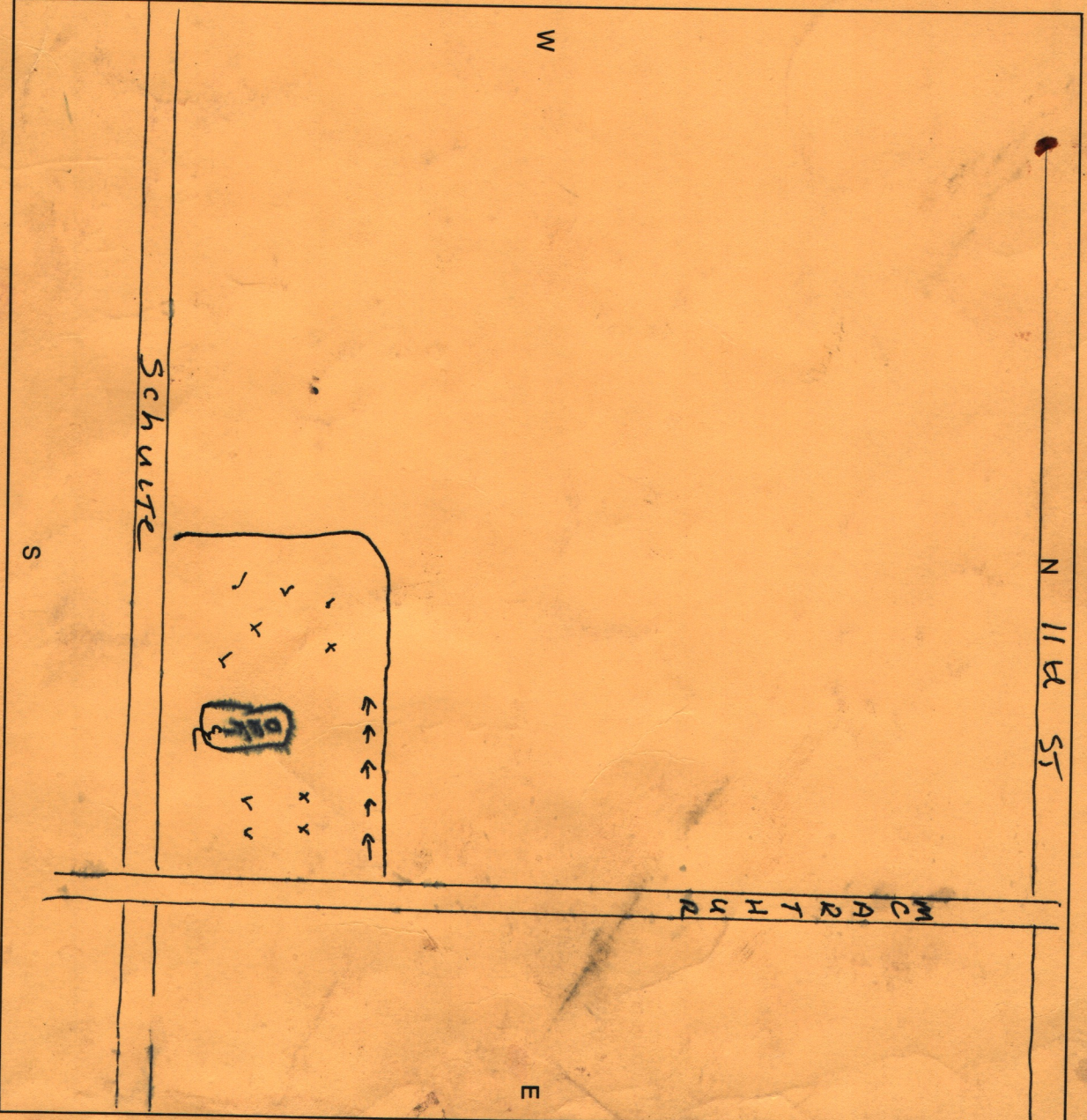

Specific Location: NW Corner of McArthur & Schulte.