

#15340

INSPECTION - TREATMENT RECORD

SAN JOAQUIN COUNTY MOSQUITO ABATEMENT DISTRICT

PROPERTY NUMBER  
Z O N E T R S  
19 15 9 19 1008

OWNER: Rocha T. Catherine  
LESSEE: Rocha Frank

ADDRESS: 23243 Jonctree Rd. Esc. CA 95230  
ADDRESS: 04,000,002

SOURCE TYPE: WATER SOURCE

SPECIFIC LOCATION:

ADDITIONAL PROPERTY INFORMATION:  
WATER SOURCE

Date	INSPECTION			Activity	Pesticide	Quantity Used			Area		No. Treated	Treatment Time	Misc. Remarks	Emp. #	Intl.
	Source #	Source Type	Genus + Instar			Gals.	Lbs.	Oz.	Ea.	Acres					
8/16/07	2	014	CxL-P	L	GG	1.0	128		.25			10.	IN-out 8:30-9:00 will come back w/	337	C
8/17/07	2	014	CxL	L	VE	5.0	40		1.25			10.	IN-out P/kw-Frank Rocha	337	C
8/17/07	3	014	CxL	L	VE	5.8	40		1.25			5.0	IN-out 9:20-9:45 solids thandgun	337	C
8/24/07	2	014	CxL	L	VE	10.0	80		2.0			15.0	IN-out 10:15-11:00	337	C
8/24/07	3	014	CxL	L	VE	10.0	80		2.0			10.0		337	C
8/24/07	1	020	Ø											337	
9/4/07	2	014	CxL-P	L	GG	10.0	1280		2.5			10.	IN-out 9:25-10:30	337	C
9/4/07	3	014	CxL-P	L	GG	10.0	1280		2.5			10.		337	C
9/4/07	4	Ø14	Ø												
9/4/07	5	Ø14	Ø												
9/4/07	1	020	CxL	L	GG	3.0	384		.75			5.0	handgun	337	C
9/11/07	2	014	CxL-P	L	GG	8.0	104		2.0			10.0	IN-out 8:57-9:40	337	C
9/11/07	3	014	CxL-P	L	GG	8.0	104		2.0			10.0		337	C
9/11/07	4	014	CxL	L	GA	2.0	256		.5			3.0		337	C
9/11/07	1	020	CxL	L	GA	4.0	512		1.0			10.0	thandgun	337	C
9/11/07	5	Ø14	Ø												
9/19/07	2	Ø14	CxL	L	GG	7.0	896		1.75			10.	IN-out 10:35-11:10	337	C
9/19/07	3	Ø14	CxL	L	GG	6.0	768		1.5			10.		337	C
9/19/07	1	020	Ø											337	C
9/24/07	2	014	CxL-P	L	GG	10.0	1280		2.5			10.0	cut corn	337	C
9/24/07	3	014	CxL-P	L	GG	10.0	1280		2.5			10.0	Solids	337	C
9/24/07	1	020	CxL-P	L	GG	5.0	640		1.25			5.0		337	C



act information:

(025) - 37° 50' 06.1" 121° 02' 03.9"

(014) - 37° 49' 56.9" 121° 02' 01.9"

(011) - 37° 49' 55.2" 121° 02' 01.8"

(011) - 37° 49' 56.0" 121° 02' 02.4"

(014) - 37° 49' 54.5" 121° 02' 05.1"

(014) - 37° 49' 59.5" 121° 01' 46.8"

(002) - 37° 49' 53.1" 121° 02' 05.0"

(002) - 37° 49' 51.8" 121° 01' 46.5"

Owner: Reba T. Colherine  
Lessee: Reba Frank

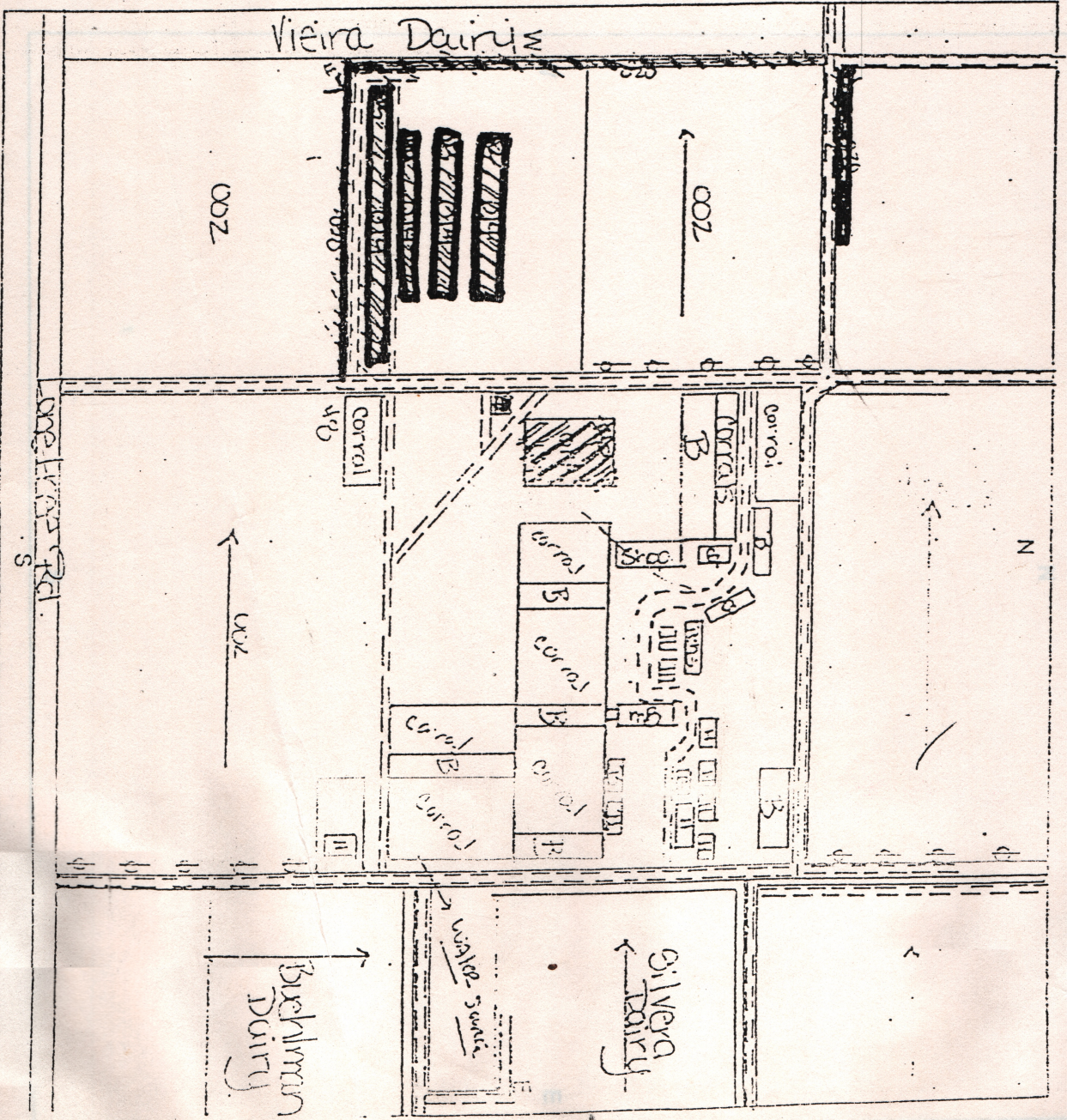

Specific Location: N side of Longview Rd. 1/2 mi. W of BREWSTER