

15339

INSPECTION - TREATMENT RECORD

SAN JOAQUIN COUNTY MOSQUITO ABATEMENT DISTRICT

PROPERTY NUMBER

OWNER: Bushman J.

ADDRESS: 2319 Onetree Rd Esc.

19-15-9E19-007

LESSEE:

ADDRESS: N side of Onetree Rd 1/4 mi. w/ of Brennan Rd.

SOURCE TYPE 014, 008, 020, 002

SPECIFIC LOCATION:

ADDITIONAL PROPERTY INFORMATION:

207-360-04

Date	INSPECTION			TREATMENT										No. Treated	Treatment Time	Misc. Remarks	Emp. #	Inti.
	Source #	Source Type	Genus + Instar	Activity	Pesticide	Gals.	Lbs.	Oz.	Ea.	Acres	Sq. ft.	Area						
9-2-06	4	014	CxL	L	GG	6.0		768		1.5				13.0			337	C
10-13-06	4	014	CxL-P	L	GG	10.0		1280		2.5				15.6			337	C
10-13-06	1	020	CxL	L	GG	4.0		512		1.0				7.0			337	C
11-1-06	4	014	CxL-P	L	GG	10.0		1280		8.5				15.0			337	C
11-1-06	1	020	CxL	L	GG	2.0		256		1.5				7.0			337	C
3-19-07	1	020	CxL	L	VE	5.0		40.0		1.25				12.0		will treat 3/20/07	337	C
3-20-07	1	020	Ø	L	VE	5.0		40.0		1.25				12.0		weed spray.	337	C
4-3-07	1	020	Ø	H	RP	95.0		32		.25				20.0		16 pt Dimer 336	337	C
4-5-07	4	014	CxL-P	L	GG	8.0		1024		2.0				25.0		not east access cant see Road needs	337	C
4-13-07	1	020	Ø	L	GG	5.0		640		1.25				10.0		share field to get to pond. 8:50-9:35	337	C
5-1-07	4	014	CxL	L	VE	8.0		64		2.0				15.0		share on field to get to pond. 9:15-9:45	337	C
5-1-07	1	020	CxL	L	VE	10.0		80		2.5				8.0		not on pond. NEEDS 1 IN OUT	337	C
5-1-07	1	020	Ø	L	VE	10.0								8.0		IN-OUT 2:10-2:55 / IN-OUT 2:00-2:18	337	C
5-1-07	4	014	CxL	L	VE	17.0		172		3.4				20.0		IN-OUT 12:40-2:00	337	C
5-1-07	6	014	CxL	L	VE	3.0		24		1.75				10.0		PLW Keith	337	C
5-1-07	1	020	CxL-P	L	GG	4.0		512		1.0				10.0		IN-OUT 10:55-11:20	337	C
5-1-07	4	014	CxL	L	VE	10.0		80		2.5				15.0		IN-OUT 9:05-9:40	337	C
5-1-07	1	020	CxL	L	VE	9.0		72		3.25				10.0		3gals to open	337	C
5-17-07	4	014	CxL	L	VE	5.0		40		1.25				5.0		IN-OUT 8:45-9:15	337	C
5-17-07	1	020	CxL	L	VE	8.0		64		2.0				10.0		IN-OUT 12:45-1:15	337	C

Contact Information:

Total

Drain Dish 37049152 & 2101313
Compsal gain WZ 37049531

Owner: Buehlyan, J.

Lessee:

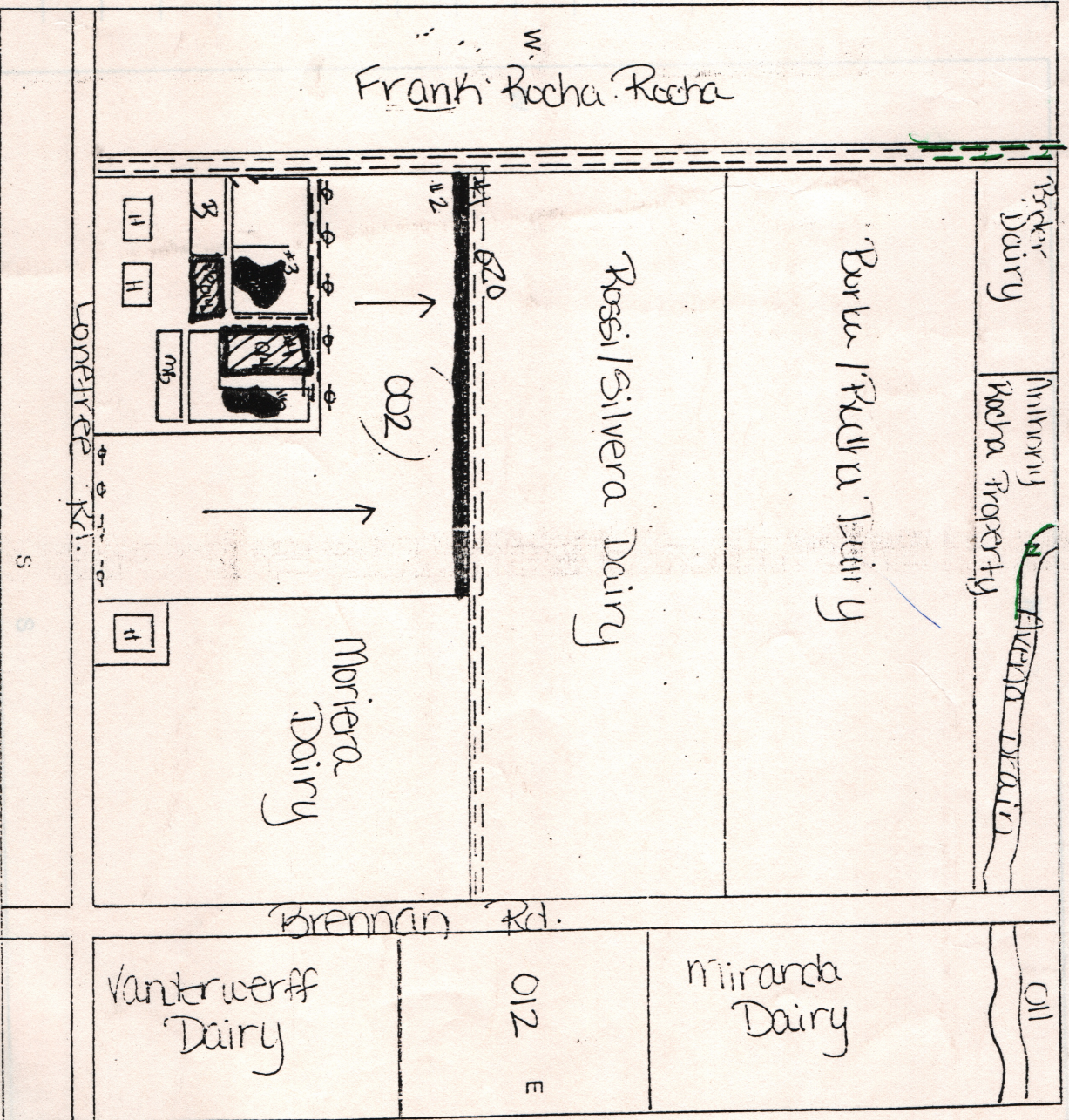

Specific Location: N side of Lonere Rd. 1/4 mi. W of Brennan Rd.