

Lower  
 121 107A

INSPECTION - TREATMENT RECORD  
 SAN JOAQUIN COUNTY MOSQUITO ABATEMENT DISTRICT

INSPECTION TOPEKA + SANTA FE RR  
 ADDRESS: 730 S. B. ST. WESTMORELAND, CA. 95205  
 OWNER: MUSHI  
 LESSEE: MUJI  
 SITE ADDRESS: W. BACON Island Rd.  
 SOURCE TYPE: 008, 004

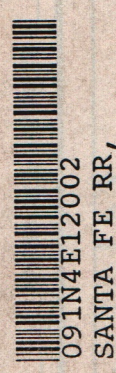

COUNTY ROAD DISTRICT # \_\_\_\_\_ COUNTY FLOOD CONTROL ZONE # \_\_\_\_\_

Date	INSPECTION		TREATMENT				No. Treated	Time	Billed (✓)	Misc. Remarks	Inti. #	
	Source Type	Genus + Instar	Activity	Pesticide	%	Quantity Used						Area
						Gals.	Lbs.	Oz.	Ea.	Acres	Sq ft.	
9/22	008	003	L	GG		20				5.0		323 ✓
10/25	006	004	L	GG		13				3.25		303 ✓
11/1	006	004	L	GG		14				3.5		323 ✓
11/8	006	002	L	<del>GG</del> UC		20				5.0		323 ✓
11/8	006	002	L	UC		16				2.5		323 ✓
11/8	023	-	L	GG		23				5.75		323 ✓
11/15	006	003	L	GG								323 ✓
12/6	006	-										323 ✓
8/10/95	002											323 ✓
1/10/96	008											323 ✓
7/19/96	008		L	VE		3				.75		323 ✓
7/19/96	002											323 ✓
7/19/96	020											323 ✓
8/14/98	020											323 ✓
9/22/98	020											323 ✓

Archive

94  
 PROPERTY NUMBER  
 ZONE T R S  
 09 1N4E 12 002  
 129 107A - 11

Contact Information: \_\_\_\_\_

Owner: \_\_\_\_\_

Lessee: \_\_\_\_\_

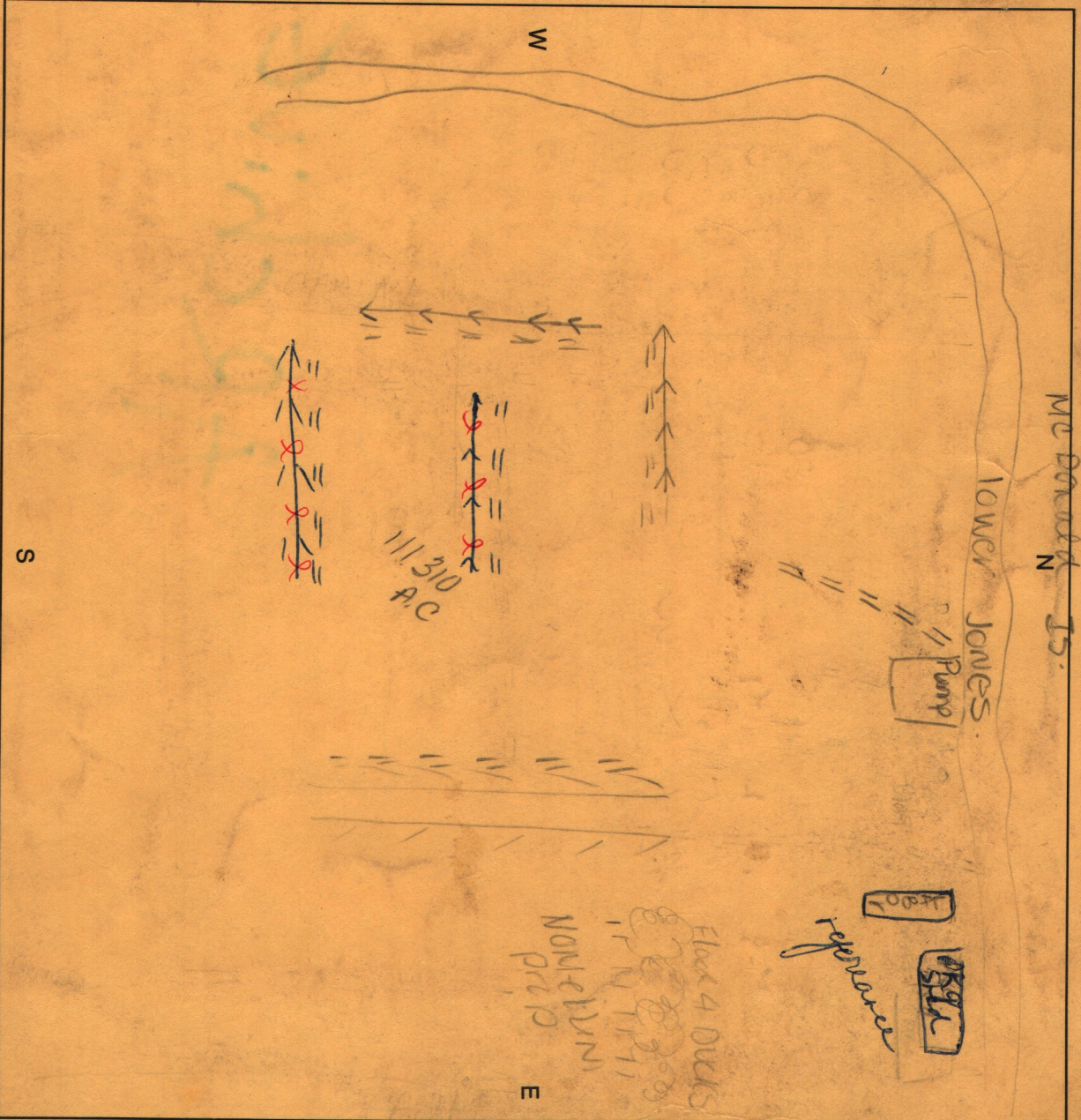

Specific Location: 111.310 A.C