

1528
PROPERTY NUMBER

19.1

HWY 120 (2006)

INSPECTION - TREATMENT RECORD
SAN JOAQUIN COUNTY MOSQUITO ABATEMENT DISTRICT

INSPECTION - TREATMENT RECORD
COSTA D. FILE

OWNER: COSTA D. ADDRESS: 15918 E. HWY 120 RIPON CA. 95366

LESSEE: ADDRESS: SOURCE TYPE 011

SPECIFIC LOCATION: S/W CORNER 120 / HARROLD 27642 E. HWY 120 ESCALON

ADDITIONAL PROPERTY INFORMATION: PH. # 209-599-3567 CA. 95320

18 25 9E 03 002
249-020-09

Date	INSPECTION			TREATMENT					No. Treated	Treatment Time	Misc. Remarks	Emp. #	Intl.	
	Source #	Source Type	Genus + Instar	Activity	Pesticide	Gals.	Lbs.	Oz.						Ea.
20 03														
4-30	1	011	0										338	CHECK REC. FOR GPS.
6-5	1	011	0										338	DRY
10-22	1	011	0										338	DITCH N. SIDE HARDING
6/30/04		011						6.65					310	
7/7	1	011	0x-L	L	AB								310	
7/23	1	011											310	
8/16	1	011											310	
8/20	1	011	0x-L	L	G G	3	384			0.75			310	
4/27	1	011	0x-L	L	G G	5	640			1.25			310	
5/11	1	011											310	
6/30	1	011											310	WATER STANDING
7/29	1	011											310	
10/6	1	011											310	
4/1/06	1	011											310	
5/2/00	1	011											310	
10/3	1	011											310	
10-24	1	011											310	
7/3/08	1	011											310	
9/29/08	1	011											317	Sweeping Arounds

Contact Information:

DGRS: ~~37° 41' 30.4"~~
~~120° 58' 08.4"~~

2009

Can not locate
source card.

books Identifiable
to 1825 9E03008

120 58 18.4 W
37 47 38 N ✓

Owner: COSTA A.

Lessee:

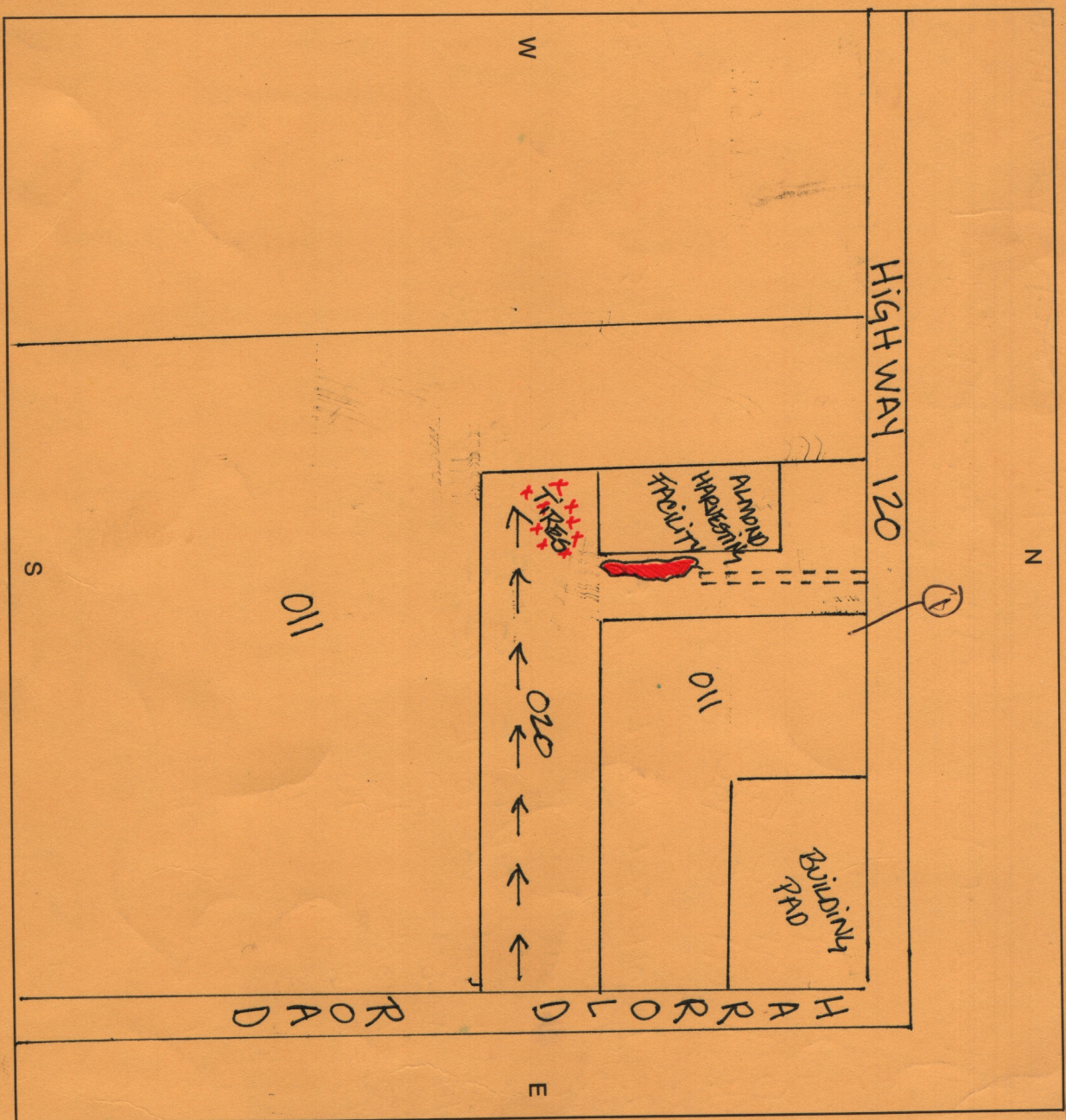

Specific Location: S/W CORNER 120 HARROLD

15135

PROPERTY NUMBER

ZONE	T	R	S
18			
72	15	9E	35
			006

INSPECTION - TREATMENT RECORD

SAN JOAQUIN COUNTY MOSQUITO ABATEMENT DISTRICT

OWNER: HICE, ERIN & Freddie

ADDRESS: 17101 Henry Rd ESC. CA

LESSEE: ADDRESS: 1 mi N/OE Hwy 120

SOURCE TYPE 003

SPECIFIC LOCATION: w/SIDE of Henry Rd

ADDITIONAL PROPERTY INFORMATION:

229-160-27

INSPECTION				TREATMENT												
Date	Source #	Source Type	Genus + Instar	Activity	Pesticide	Gals.	Lbs.	Oz.	Ea.	Acres	Sq. ft.	No. Treated	Treatment Time	Misc. Remarks	Emp. #	Intl.
10/19/04	003	003													336	
3/8/05	003	003													336	
4/19/05	003	003													336	
5/3	003	003													336	
6/10	003	003													336	
6/17	003	003													336	
6/20	003	003													336	
8/2	003	003	00-L	L	GG	1		128		.25			10		336	
8/24	003	003	00-L	L	GG	1		128		.25			10		336	
9/15	003	003													336	
9/29	003	003													336	
10/27	003	003													336	
6/5/06	003	003	AE-L	L	GG	1		128		0.25			10		336	
9/10	003	003	AE-L	L	GG	1		128		0.25			10		336	
9/16	003	003	AE-L	L	GG	2		256		0.5			10		336	
9/29	003	003	AE	L	GG	2		256		0.5			10		336	
10/11	003	003	AE	L	GG	3		384		0.5			15		336	
4/17/07	003	003													336	
4/18	016	016		X	FS			1.0	60			10	40	Troughs need fish + PNO	336	
4/18	043	043		X	FS			1.0	60				22	ALLOW PROPERTY	336	
6/13	003	003	AE	L	GG	1.0		128		.25				OUT - 8:45	336	
7/23/07	003	003	AE	L	VE	4.0		32		1.0				OUT - 10:50	336	
8/4/07	003	003												pasture dry	304	

Contact Information: _____

Owner: Hice, Erin & Freddie

Lessee: _____

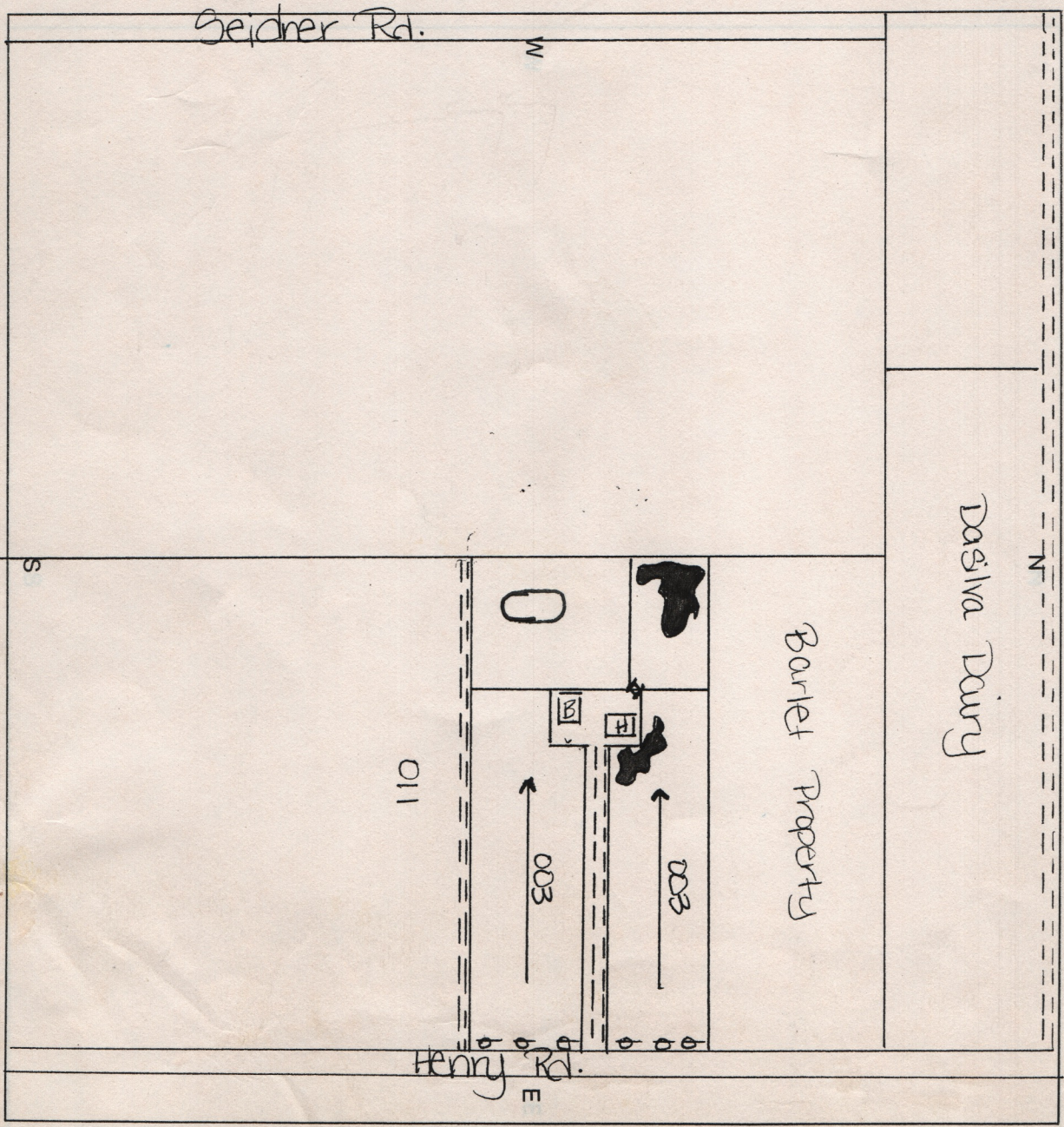

Specific Location: W side of Henry Rd. 1 mi. N of Hwy 120