

LOC # 15136

File / New Card on File

INSPECTION - TREATMENT RECORD SAN JOAQUIN COUNTY MOSQUITO ABATEMENT DISTRICT

OWNER: DASILVA Brothers DAIRY ADDRESS: 16551 Henry Rd ESC CA
 LESSEE: JOE DASILVA ADDRESS: 16880 Henry Rd SOURCE TYPE 014, 020, 009, 002
 SPECIFIC LOCATION: _____

PROPERTY NUMBER
 ZONE T R S

10 15 9E35 007

ADDITIONAL PROPERTY INFORMATION: _____

229-160-4

Date	INSPECTION			TREATMENT										Emp. #	Int.
	Source #	Source Type	Genus + Instar	Activity	Pesticide	Gals.	Lbs.	Oz.	Ea.	Acre	Sq. ft.	No. Treated	Treat-ment Time		
6/20	3	008	CX	L	GG	2.0	256			.50			5.0	IN - 10:30	306
6/20	4	002	CX	L	GG	1.0	120			.25			5.0	IN - 10:40	306
6/26	5	014	CX-L	L	VE	3	24			.75			4	Blower (12:45 - 1:20)	317
6/26	7	014	CX-L	L	VE	10	80			2.50			8	Blower	317
7/20/07		005		X	PS		.5	30			300		10.0	IN-DIRT 11:00-12:05	
7-31-07	5-7	014	CX-P	L	GG	7	896			1.75			15	8:25-9:00	306
7-31-07		020											10	10:00-10:15	306
8-6-07	5	014	CX-L	L	XG	5	80			1			10		306
8-6-07	7	014	CX-P	L	GG	4	512			1			10	pond by house is fine	306
8-6-07	3	008	CX-L	L	AP	2	32			.8			15		306
8-6-07	4	020	CX-L	L	AB		855	45		4500			15	10:25-11:55	306
8-15-07	2	020	CX-L	L	AB		425	25		2500			15		306
8-15-07	2	008	CX-L	L	AX		192	15		2000			10		306
8-15-07	2	002	CX-P	L	GG	6	768			1.5			15	9:05-10:20	306
8-15-07	516	014	CX-P	L	GG	9	1152			2.25			20		306
8-15-07	748	014	CX-P	L	GG	10	1280			2.5			20		304
8-15-07	2	020	CX-P	L	GG	2	254			.5			10	10:15-11:20	306
8-21-07	547	014	CX-P	L	GG	22	2816			5.5			25	Ponds are winding up	306
8-21-07	547	014	CX-L	L	VE	14	112			3.5			25	9:45-10:50	306
8-27-07	547	014	CX-L	L	GG	11	1738			2.75			30	10:15-11:15 gully weeds	306
8-27-07	567	014	CX-L	L	VE	15	120			3.75			10		304
8-27-07	567	014	CX-A	A	PO	15	15			3.75			10	1:40-2:00	304

Contact Information: _____

Owner: _____

Lessee: _____

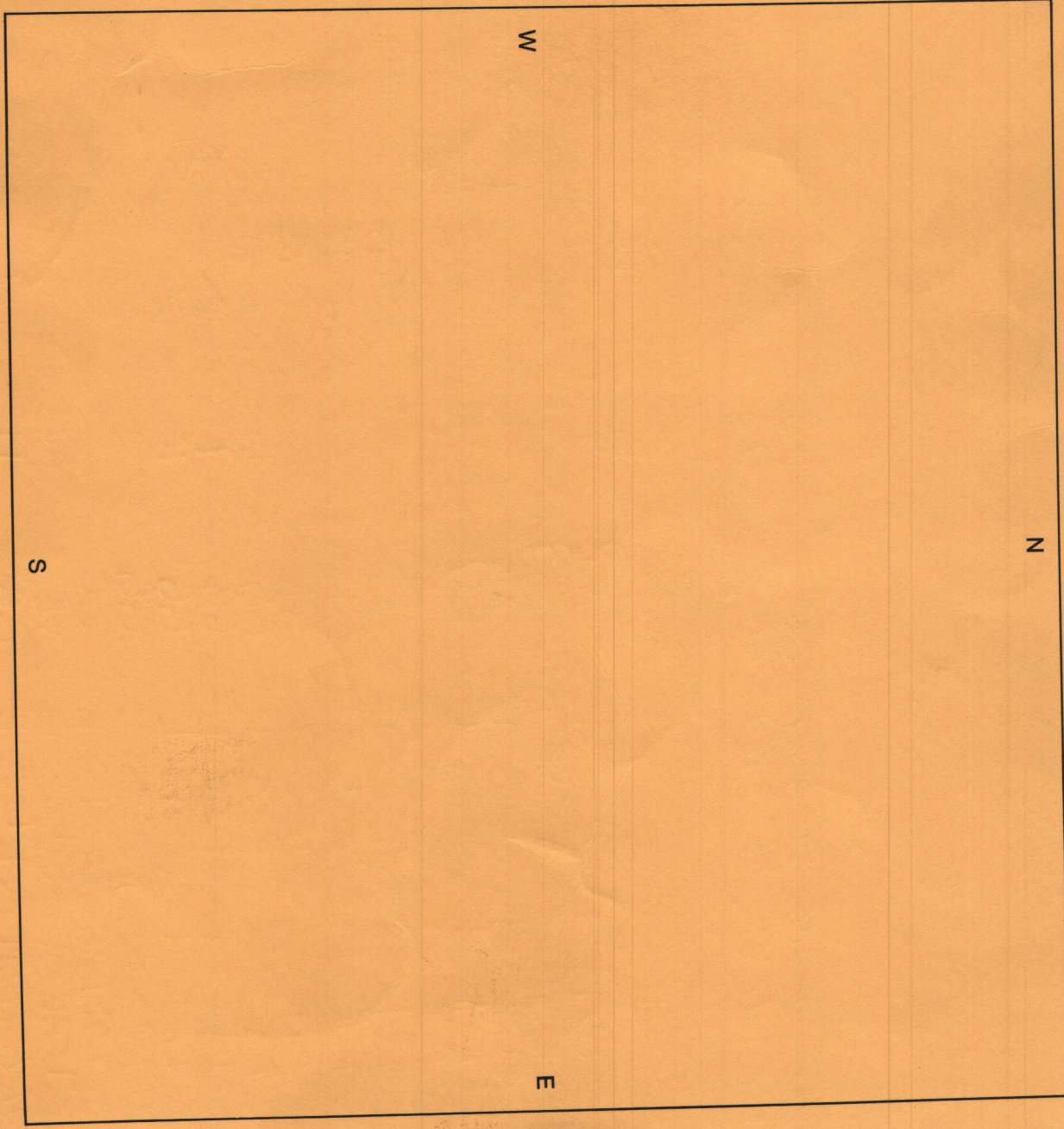

Specific Location: _____

Contact Information:

① GPS = 37°49' 23.1"

120° 56' 43.8"

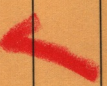

Owner: Robbels, Gilbert & Delores

Lessee: _____

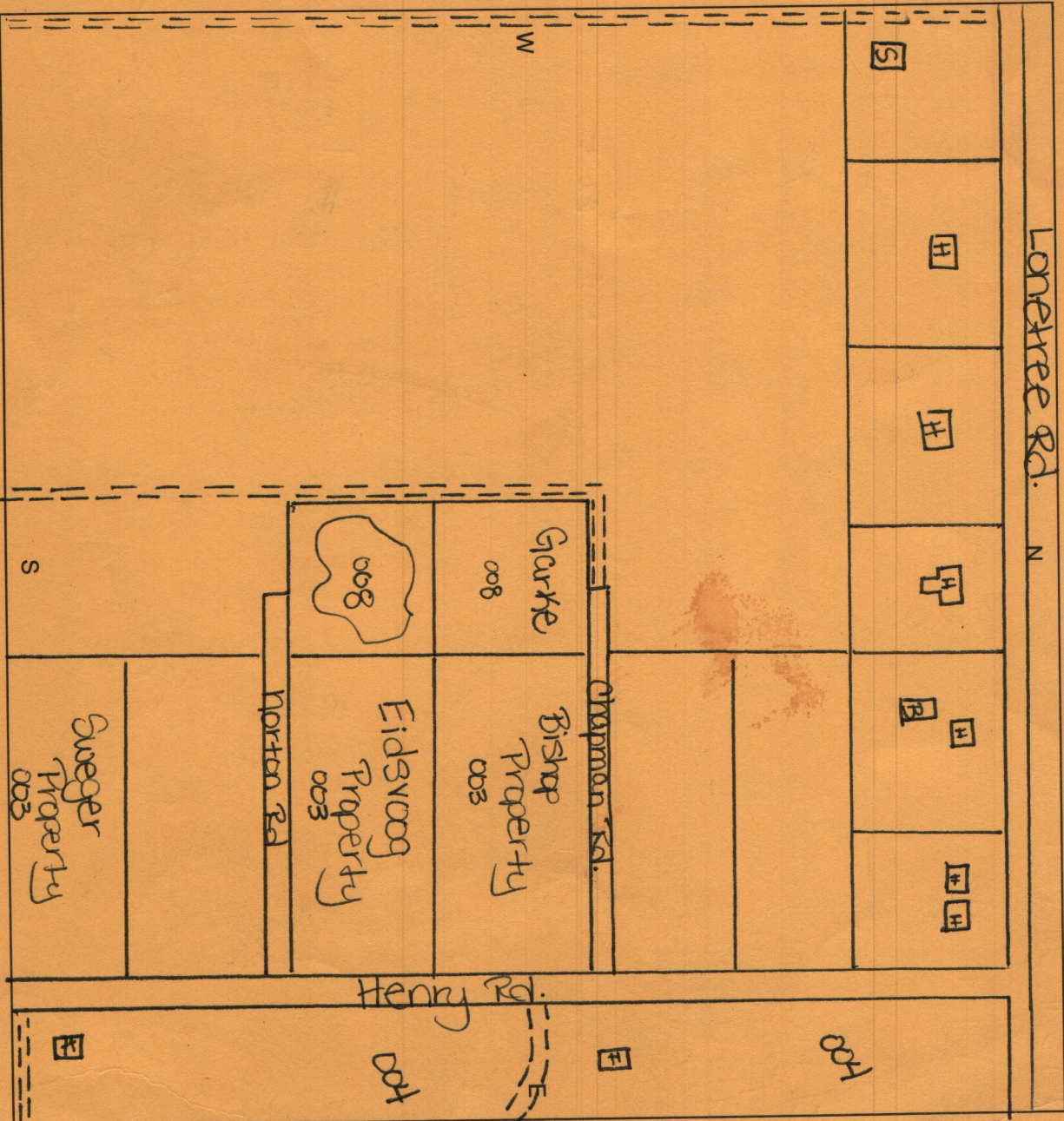

Specific Location: w/ side of Henry Rd. w/ end of Norton Rd.

N side