

INSPECTION - TREATMENT RECORD SAN JOAQUIN COUNTY MOSQUITO ABATEMENT DISTRICT

PROPERTY NUMBER
ZONE T R S

187269E12 003

249-150-03

OWNER: COSTA TRUST. ADDRESS: 30836 COMBS RD ESCALON

LESSEE: 30836 COMBS RD ADDRESS: 30836 COMBS SOURCE TYPE 011-021

SPECIFIC LOCATION: 21822 MC BRIDE RD ESCALON

ADDITIONAL PROPERTY INFORMATION: PROPERTY (CORCHARD) DIRECTLY WEST OF McEVELL PROP. 30.1 ACKES

| INSPECTION | | TREATMENT | | | | | | | | | | Emp. # | Intl. | | | | |
|------------|----------|-------------|----------------|------|----------|-----------|-------|------|-----|-----|-------|--------|-------|---------|------------------------------------|----------------|---------------|
| Date | Source # | Source Type | Genus + Instar | Time | Activity | Pesticide | Gals. | Lbs. | Oz. | Ea. | Acres | | | Sq. ft. | No. Treated | Treatment Time | Misc. Remarks |
| 6-11 | | | NEW OPARD. | | | | | | | | | | | | | | |
| 8-22 | 1 | 011 | 02L | 1.0 | L | AP | | 50.8 | | | .15 | | | 20.0 | 610 37° 47.036' 120° 55.905' | 338 | |
| 6/21/04 | 1 | 011 | | 15 | | | | | | | | | | | | | 330 |
| 7/2/04 | 1 | 011 | | 10 | | | | | | | | | | | | | 330 |
| 8/19 | 1 | 011 | | 10 | | | | | | | | | | | | | 330 |
| 9/15 | 1 | 011 | | 10 | | | | | | | | | | | | | 330 |
| 5/17/05 | 1 | 011 | | 15 | | | | | | | | | | | | | 330 |
| 5/16 | 1 | 011 | | 15 | | | | | | | | | | | | | 330 |
| 6/14 | 1 | 011 | | 11 | | | | | | | | | | | | | 330 |
| 7/11 | 1 | 011 | | 10 | | | | | | | | | | | | | 330 |
| 7/28 | 1 | 011 | CF-L | 5 | L | GG | 2 | | 250 | | 0.5 | | | 10 | | | 330 |
| 8/26 | 1 | 011 | | 5 | | | | | | | | | | | | | 330 |
| 2/7 | 1 | 011 | | 20 | | | | | | | | | | | | | 330 |
| 8/24 | 1 | 011 | | 10 | | | | | | | | | | | | | 330 |
| 9/21 | 1 | 011 | CF | 10 | L | GG | 3 | | 384 | | 0.75 | | | 15 | | | 330 |
| 10-5 | 2 | 021 | CF | 5 | L | GG | 5 | | 640 | | 1.25 | | | 15 | | | 330 |
| 11/5 | 2 | 021 | | 10 | | | | | | | | | | | | | 330 |
| 2-26-08 | 1 | 011 | O | 10 | | | | | | | | | | | | | 330 |

HEAVY VEG IN 011

Contact Information: _____

9-7-09 Joe was mowing

basin water was seeping through grass. Constant

water source irrigation pipe leaks. Killing trees in front of property.

10-24-07

Trees are dead in back dying in front property gets too much water.

2-26-08 New orchard

Planted. Ground still not level. Water still sitting on property.

5-6-08 water water level water on D20 to hold fish.

Owner: COSTA

Lessee: _____

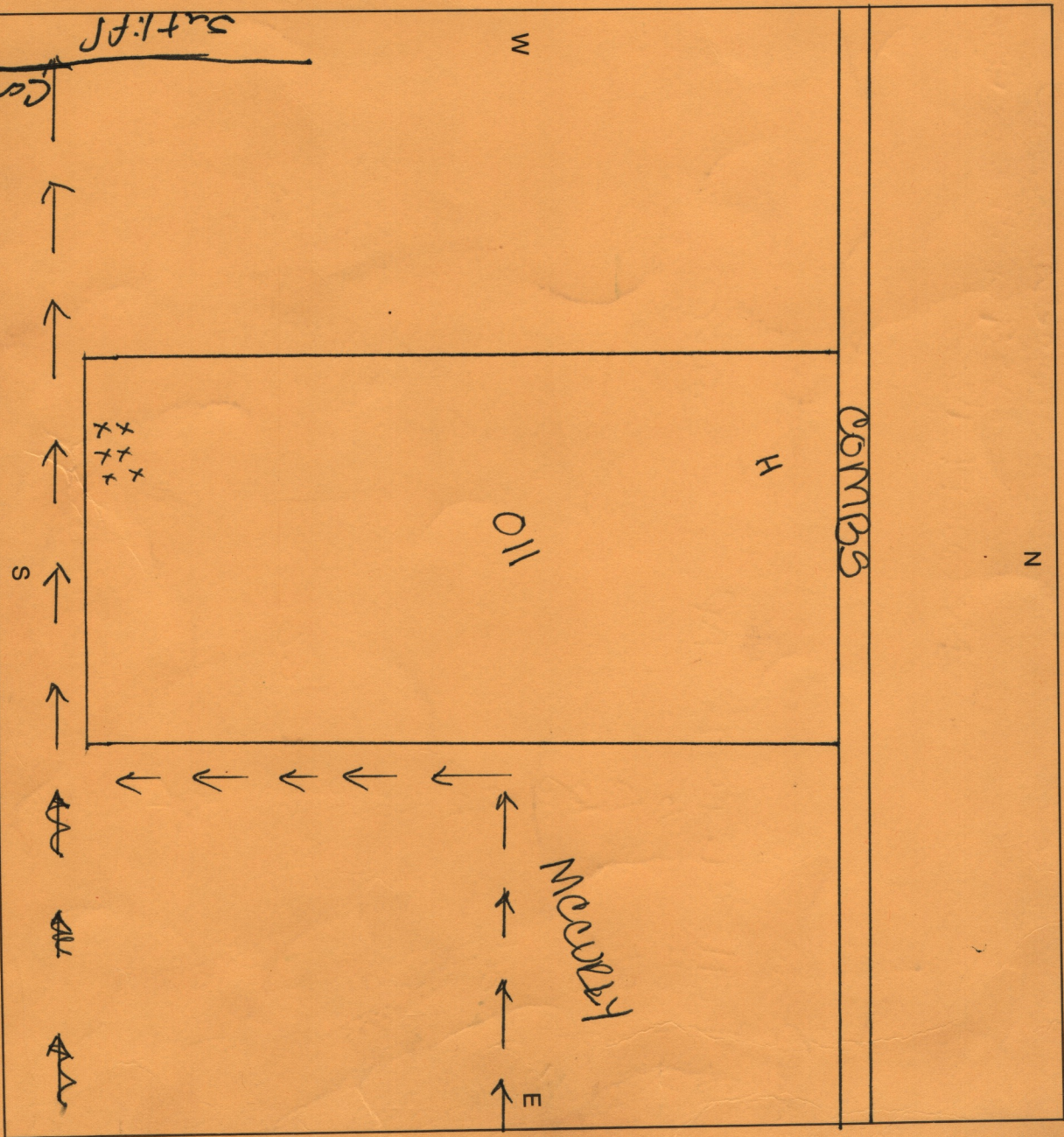

Specific Location: _____